

Tumble dryer

T5350

Features and benefits

- High productivity – 2 full loads per hour
- Low energy consumption for optimal efficiency
- Large door opening for easy loading and unloading
- Large selfcleaning lint screen for easy maintenance
- Reversible door hanging for a convenient laundry flow
- Easy access to vital parts from front and rear for simple servicing
- With Compass Pro program control
 - Large display and one control knob for easy program selection
 - Language selection
 - Quick selection and option buttons for the most frequently used drying programs and options
 - Drying program packages optimized for Economy, Care and Time and option buttons for selection of dryness
 - Service program for adjustment of parameters
 - USB connection
- The coin version with Ecopower to avoid over drying of the garments and get a lower energy consumption

Main options

- Stainless steel front
- Stainless steel drum
- Residual Moisture Control – RMC
- Reversing drum
- Payment: coinmeter with Ecopower, chipcard reader, CP connection
- Special versions (dryer + option package): Lagoon® variant includes stainless steel front, stainless steel drum, RMC and reversing drum
- Fresh air intake
- Supply disconnecter
- CMIS (Certus Management Information System)



Images shown are a representation of the product only and variations may occur.

Main specifications			T5350			
Rated capacity,	filling factor 1:18	kg/lb	19.4/42.8			
	filling factor 1:22	kg/lb	15.5/34.2			
Drum volume		litre	349			
Drum diameter		mm	760			
Heating,	electric	kW	13.2/13.5/18.0			
	gas	BTU/h (kW)	71700 (21.0)			
	steam at 800 kPa		25.0			
Consumption data*			13.5 kW	18.0 kW	Gas	Steam
Total time full load		min	38	27	24	22
Energy consumption full load		kWh	8.2	7.7	8.4	11.7
Evaporation		g/min	211	289	342	359
Energy kWh/litre water evaporated		kWh/l	1.02	0.99	1.03	1.48

* At rated capacity 100% cotton load at 50% initial moisture dried to 0%.

Electrical connections					
Heating alternative	Main voltage		Heating power kW	Total power kW	Recommended fuse A
		Hz			
Electric heated	220-240V 3 ~	50/60	13.5/18.0	14.6/19.1	50
	380-415V 3N ~	50/60	13.5/18.0	14.6/19.1	25/35
	440V 3 ~	60	13.5/18.0	14.6/19.1	25/35
	480V 3 ~	60	13.5/18.0	14.6/19.1	20/25
	115V 3 ~	60	13.2	14.3	80
Gas heated/ Steam heated	220-240V 3 ~	50/60	-	1.1	10
	380-415V 3N ~	50/60	-	1.1	10
	440V 3 ~	60	-	1.1	10
	480V 3 ~	60	-	1.1	10

Steam, gas and air connections			T5350	
Steam	ISO 7/1-R		1"	
Steam pressure		kPa	100-1000	
Steam consumption		kg/h	65	
Condensate	ISO 7/1-R		1"	
Gas	ISO 7/1-R		1/2"	
Gas pressure	Natural gas	Pa	2000	
		mbar	20	
	Propane	Pa	2800-5000	
		mbar	28-50	
Air outlet		ø mm	200	
Evacuated air,	el 13.5 kW	m ² /h	600	
			el 18 kW	1000
			gas 21 kW	1000
			steam	1000
Pressure drop	el 13.5 kW	Max. Pa	520	
			el 18 kW/gas 21 kW/steam	270
Sound levels				
Airborne sound level		dB(A)	<70	
Heat emission				
% of installed power, max			15	
Shipping data*				
Weight		net, kg	177	
Shipping volume		crated, m ³	1.96	
Dimensions in mm				
A	Width		790	
B(a)	Depth, el and gas		1177	
B(b)	Depth, steam		1344	
C	Height		1770	
D			785	
E			840	
F			108	
G			66	
H			278	
I			171	
J			172	
K			395	
L			605	
M			747	
1	Operating panel			
2	Door opening ø 580 mm			
3	Electrical connection			
4	Gas connection			
5	Exhaust connection			
6	Steam: in			
7	Steam: out			

* Average data. Crated weight/shipping volume depends on configuration. Please contact logistics for exact measures.

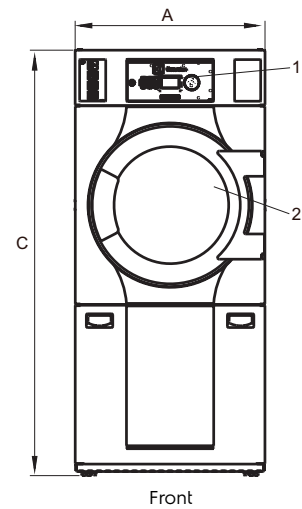

Front

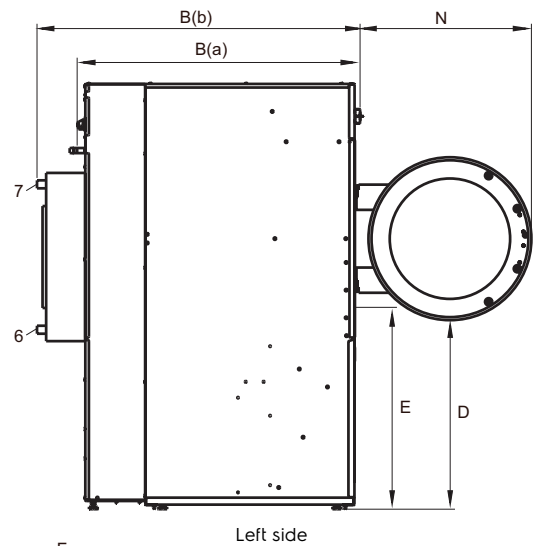

Left side

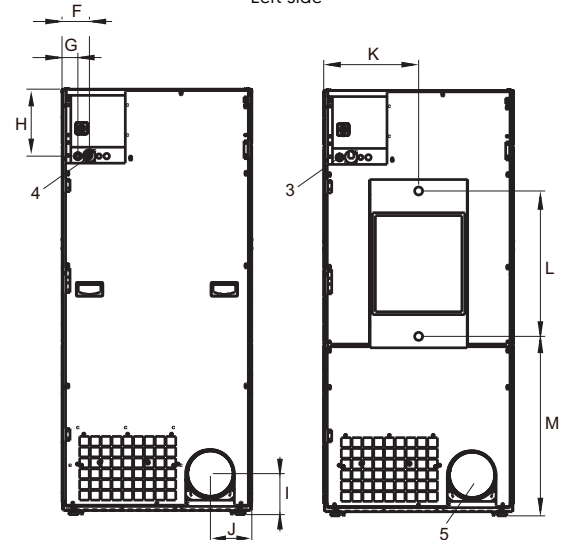

El, gas

Steam

Rear side